



Duke Elephant

*height aprox. 5,5 inch/14 cm
if using sport weight yarn*

Hello!

First of all:

- This pattern use US terms
- Using sport weight yarn on a C/2 (2.5 mm) crochet hook, the amigurumi will measure 5,5 inch (14 cm) total.
- You crochet continuously in a spiral. You don't have to close each round with a slip stitch.

Materials

- sport weight yarn in **gray**
- a bit of sport weight yarn in **off-white** for the tusks
- C/2 (2.5 mm) crochet hook
- brown embroidery thread
- fiberfill
- a pair of safety eyes (6 mm)
- tapestry needle, stitch marker, scissors...



Abbreviations

- ch:** chain stich
- dec:** decrease
- inc:** increase
- rnd(s):** round(s)
- sc:** single crochet
- sc-BLO:** single crochet through back loop only
- slst:** slip stich
- st(s):** stich(es)

Tusks (make 2)

(in off white)

rnd.		sts.
01.	4 sc in a magic ring	[04]
02.	(sc, inc)x2	[06]
03.	sc in all 6 sts	[06]

Slst, fasten off

Head and body

(in gray)

rnd.		sts.
01.	6 sc in a magic ring	[06]
02.	inc in all 6 sts	[12]
03.	(sc, inc)x6	[18]
04.	(2 sc, inc)x6	[24]
05.	(3 sc, inc)x6	[30]
06.	(4 sc, inc)x6	[36]
07.	36 sc, ch 8. Start in the second chain from the hook: 7 sc (1-3)	[43]
08.	36 sc. On the other side of the foundation chain: 6 sc, inc in next st. 7 sc (4-6)	[51]
09.	17 sc, inc in next 2 sts, 23 sc, sc in next 3 sts, 6 sc	[56]
10.	45 sc, (inc, sc)x2, inc, 6 sc	[59]

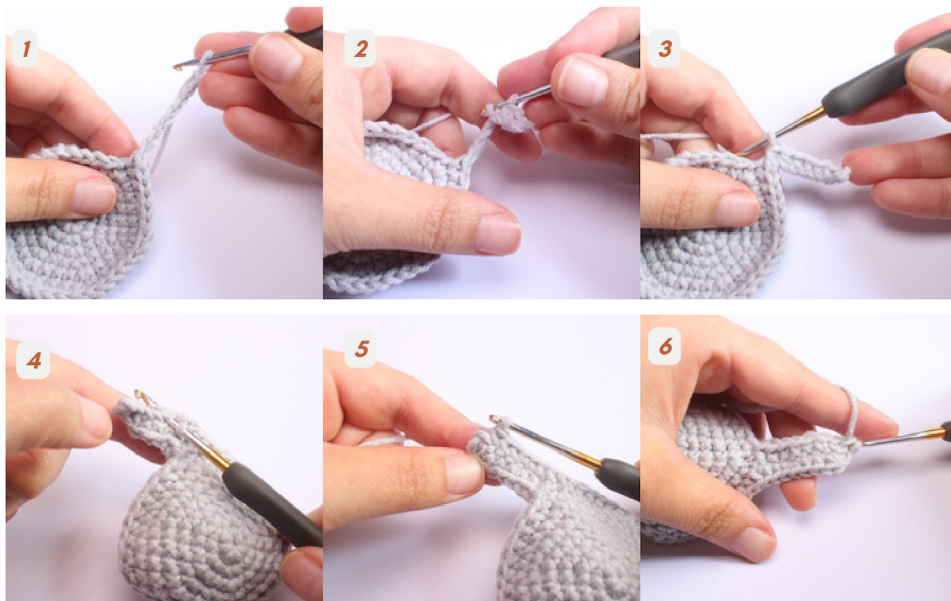

rnd.

sts.

11. 17 sc, inc, 2 sc, inc, 24 sc, (inc, 2 sc)x2, inc, 7 sc [64]
12. 48 sc, (inc, 3 sc)x2, inc, 7 sc [67]
13. 17 sc, inc, 4 sc, inc, 25 sc, (inc, 4 sc)x2, inc, 8 sc [72]
14. 51 sc, (inc, 5 sc)x2, inc, 8 sc [75]
15. 17 sc, inc, 6 sc, inc, 26 sc, (inc, 6 sc)x2, inc, 9 sc [80]
16. 54 sc, (inc, 7 sc)x2, inc, 9 sc [83]
17. 54 sc, (inc, 8 sc)x2, inc, 10 sc [86]
18. 12 sc. Take the first tusk, join the tusk to the head with 3 sc in both pieces (right sides together), 14 sc. Take the second tusk, join the tusk to the head with 3 sc in both pieces, 54 sc (7-9) [86]
19. 12 sc, s3 sc of the first tusk, sc, ch 6, skip 12 sts, sc, 3 sc of the second tusk, 54 sc (10-12) [80]
20. sc in all 80 sts (13-15) [80]
21. (6 sc, dec)x4, 48 sc [76]
22. (5 sc, dec)x4, 48 sc [72]
- 23-30. [8 rnds] sc in all 72 sts [72]

Place the eyes between round 15 and 16. The distance from one eye to the other is 18 stitches

Stuff the head and continue stuffing as you go



rnd.

31. ch 4, skip 14 sts, 2 sc, ch 4, skip 14 sts, 3 sc, ch 4, skip 17 sts,
2 sc, ch 4, skip 17 sts, 3 sc (16-19)

sts.

[26]

32-33. [2 rnds] sc in all 26 sts

[26]

4 sc, slst. Fasten off, leaving a long tail for sewing



Trunk

(in gray)

rnd.

01. Join the yarn. Sc in each unworked stitch of the tusk

sts.

[18]

02 sc in all 18 sts

[18]

03. (7 sc, dec)x2

[16]

04. Sc in all 16 sts

[16]

05. (6 sc, dec)x2

[14]

06. Sc in all 14 sts

[14]

07. (5 sc, dec)x2

[12]

08. Sc in all 12 sts

[12]

09. (4 sc, dec)x2

[10]

10. Sc in all 10 sts

[10]

rnd.

11. (3 sc, dec)x2

sts.

[08]

12. Sc in all 8 sts

[08]

13. Sc-BLO in all 8 sts

[08]

Fasten off.

Weave the yarn tail through the front loop of each remaining stitch and pull tight to close. Weave in the yarn end.

Stuff the trunk.



Front Legs

(in gray)

- | rnd. | | sts. |
|---------------|--|-------------|
| 01. | Join the yarn. Sc in each unworked stitch of the front leg | [18] |
| 02. | sc in all 18 sts | [18] |
| 03. | (7 sc, dec)x2 | [16] |
| 04-06. | [3 rnds] sc in all 16 sts | [16] |
| 07. | Sc-BLO in all 16 sts | [16] |
| 08. | 8 dec | [08] |
- Fasten off. Weave the yarn tail through the front loop of each remaining stitch and pull tight to close. Weave in the yarn end.*



Back Legs

(in gray)

- | rnd. | | sts. |
|-------------|---|-------------|
| 01. | Join the yarn. Sc in each unworked stitch of the back leg | [21] |
| 02. | Sc in all 21 sts | [21] |
| 03. | (5 sc, dec)x3 | [18] |
| 04. | Sc in all 18 sts | [18] |
| 05. | (7 sc, dec)x2 | [16] |
| 06. | Sc in all 16 sts | [16] |
| 07. | Sc-BLO in all 16 sts | [16] |
| 08. | 8 dec | [08] |
- Fasten off. Weave the yarn tail through the front loop of each remaining stitch and pull tight to close. Weave in the yarn end.*



Sewing

Stuff the body and the legs. Using a tapestry needle, sew the belly. Weave in the yarn end.



Ears

(in gray)

- **Left ear**

- | rnd. | sts. |
|---|-------------|
| 01. Ch 9. Start in the second chain from the hook:
7 sc, 3 sc in next st. On the other side of the
foundation chain: 6 sc, inc | [18] |
| 02. Inc, 6 sc, inc in next 3 sts, 6 sc, inc in next 2 sts | [24] |
| 03. 8 sc, inc in next 6 sts, 10 sc | [30] |
| 04. 9 sc, (inc, sc)x5, inc, 10 sc | [36] |
| 05. 10 sc, (inc, 2 sc)x5, inc, 8 sc
2 sc, slst. Fasten off, leaving a long tail for
sewing | |



- **Right ear**

Follow the pattern of the left ear until round 4.

rnd.

05. 10 sc, (inc, 2 sc)x5, inc, 10 sc **[42]**

2 sc, slst. Fasten off, leaving a long tail for sewing

Assembly



Thanks!

 @amifauna

 @amifauna