

Tony The Beagle

Sorrel, White & Black Color



@pikicraftvn

SKILL LEVEL:

Rnd: round

Ch: chain stitch

slst: slip stitch

sc: single crochet stitch

st, sts: stitch, stitches

dec: single crochet 2 stitches in front loops together

inc: single crochet 2 stitches in same sc

hdc: half double crochet stitch

dc: double crochet stitch

inc-hdc: half double crochet increase

BLO: crochet through back loops only

FLO: Crochet through front loops only

< . . . >: join the < c o l o r > yarn

(...) x : repeat instructions in bracestimes

NOTE:

when changing color and join yarn:

- Work in the previous color yarn until two loops of the last stitch remain on the hook.
- Use the new color yarn to complete the stitch, continue working with the new color yarn.

Do not cut color yarn that will be needed later on.

I use black thread or smaller black yarn for embroidering.

It's highly recommended that you read through the pattern completely before beginning to crochet.

MATERIALS

Worsted yarn



Sorrel yarn



White yarn



Black yarn

Crochet Hook 2.5mm

Stuffing Fiberfill

Safety Nose 6mm

Safety Eyes black 6mm x 2

SIZE: 16cm (6.3 inches)
(If using fingering weight yarn
on a 2.5mm crochet hook)



HEAD

Begin with sorrel yarn:

Rnd 1: 6 sc in the magic ring [6]

Rnd 2: 6 inc [12]

Rnd 3: (1 sc, 1 inc) x 6 [18]

Rnd 4: (2 sc, 1 inc) x 6 [24]

Rnd 5: (3 sc, 1 inc) x 6 [30]

Rnd 6: (4 sc, 1 inc) x 6 [36]

Rnd 7: < sorrel > 17 sc, < white > 1 sc,

< sorrel > 18 sc [36]

Rnd 8: < sorrel > 16 sc, < white > 3 sc,

< sorrel > 17 sc [36]

Rnd 9: < sorrel > 16 sc, < white > 3 sc,

< sorrel > 17 sc [36]

Rnd 10: < sorrel > 16 sc, < white > 3 sc,

< sorrel > 17 sc [36]

Rnd 11: < sorrel > (2 sc, 1 inc) x 5, < white > 2 sc,

1 inc, 2 sc, < sorrel > inc, (2 sc, 1 inc) x 5 [48]

Rnd 12 - Rnd 15: sc in all 48 st [48]

Insert the safety eyes between rounds 10 and 11,

with an interspace of 6 stitches.

Rnd 16: (4 sc, 1 dec) x 8 [40]

Rnd 17: (3 sc, 1 dec) x 8 [32]

Rnd 18: (2 sc, 1 dec) x 8 [24]

Fill the head with stuffing material.

Rnd 19: BLO (1 sc, 1 dec) x 8 [16]

Fasten off and leave a long tail for sewing.

Embroider eyebrows on round 7 with black thread.



EARS

INNER EAR (*2):

Begin with sorrel yarn:

Rnd 1: Chain 14, 1 hdc on the 3rd chain
FROM THE HOOK, 6 hdc, 4 dc on the chain,
5 dc in the last stitch, 4 dc on the other side of the
chain, 7 hdc [27]

OUNER EAR (*2):

Begin with sorrel yarn:

Rnd 1: Chain 14, 1 hdc on the 3rd chain
FROM THE HOOK, 6 hdc, 4 dc on the chain,
5 dc in the last stitch, 4 dc on the other side of
the chain, 7 hdc [27]

Rnd 2: Put the inter ear in front then crochet
through both pieces: 7 sc, 4 hdc, 5 inc-hdc,
4 hdc, 7 sc, 1 chain, 4 hdc [36]

Fasten off and leave a long tail for sewing.

Sew the ear to the head between Rnd 5 and 6.



SNOUT

Begin with white yarn:

Rnd 1: Chain 6, 1 inc on the 2nd chain from the hook, 3 sc, 4 sc in the last st, 3 sc on the other side of the chain, 1 inc in the last st [14]

Rnd 2: 7 sc, 2 inc, 3 sc, 2 inc [18]

Rnd 3: 8 sc, 3 inc, 4 sc, 3 inc [24]

Rnd 4: 9 sc, 1 hdc, 3 dc, 1 hdc, 1 sc, 2 slst, 1 sc, 1 hdc, 3 dc, 1 hdc, 1 sc [24]

Rnd 5: FLO 15 sc, 2 slst, 7 sc [24]

Fasten off and leave a long tail for sewing.

Embroider snout same pic with black thread.

Insert the safety snout between Rnd 2 and 3.

Sew the snout to the head between Rnd 11 and 17.

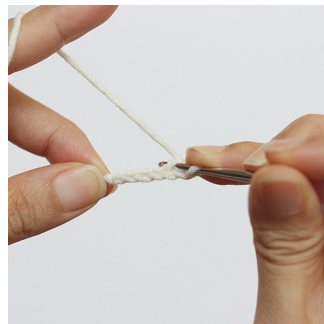
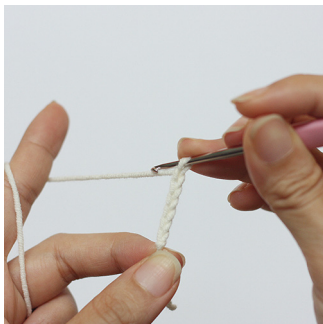

TAIL

Begin with white yarn:

Rnd 1: 4 sc in the magic ring [4]

Rnd 2: inc, 3 sc [5]

Rnd 3 - Row 4: 5 sc [6]

Change the color to black yarn:

Rnd 5: 5 sc [5]

Rnd 6 - Rnd 8: 5 sc [5]

Fasten off and leave a long tail for sewing.

Sew the tail to the body between round 2 and 3.



BODY

First, we start with the neck. Begin with black yarn:

Rnd 1: Chain 16, connect first chain to MAKE A RING, continue working in a spiral 16 sc [16]

Rnd 2: Chain 13, 1 sc on the 2nd chain

FROM THE HOOK, 11 sc on the chain, 1 sc in the stitch where the foundation chain starts, 16 sc on the neck, 11 sc on the other side of the chain, 3 sc in the last st [43]

Place the stitch marker in the next stitch.

Rnd 3: <black> 1 sc, 1 inc, 13 sc, 1 inc, 2 sc, <white> 1 inc, 2 sc, 1 inc, <black> (2 sc, 1 inc) x 2, 14 sc, 1 inc [50]

Rnd 4: <black> 2 sc, 1 inc, 17 sc, <white> 6 sc, <black> 22 sc, 1 inc, 1 sc [52]

Rnd 5: <black> 3 sc, 1 inc, 17 sc, <white> 1 inc, 4 sc, 1 inc, <black> 22 sc, 1 inc, 2 sc [54]

Rnd 6: <black> 4 sc, 1 inc, 17 sc, <white> 1 inc, 6 sc, 1 inc, <black> 22 sc, 1 inc, 3 sc [60]

Rnd 7: <black> 23 sc, <white> 10 sc, <black> 27 sc [60]

Rnd 8: <black> 4 sc, <coral> 2 sc, <black> 10 sc, <coral> 3 sc, <black> 4 sc, <white> 10 sc, <black> 3 sc, <coral> 2 sc, <black> 12 sc, <coral> 3 sc, <black> 7 sc [60]

Rnd 9: <black> 3 sc, <coral> 5 sc, <black> 6 sc, <coral> 8 sc, <white> 12 sc, <coral> 5 sc, <black> 9 sc, <coral> 6 sc, <black> 6 sc [60]

Rnd 10: <black> 2 sc, <coral> 19 sc, <white> 14 sc, <coral> 25 sc [60]

Rnd 11: <coral> 8 sc, <white> 9 sc, <coral> 2 sc, <white> 18 sc, <coral> 3 sc, <white> 13 sc, <coral> 3 sc, <white> 4 sc [60]

do not cut yarn to continue the leg

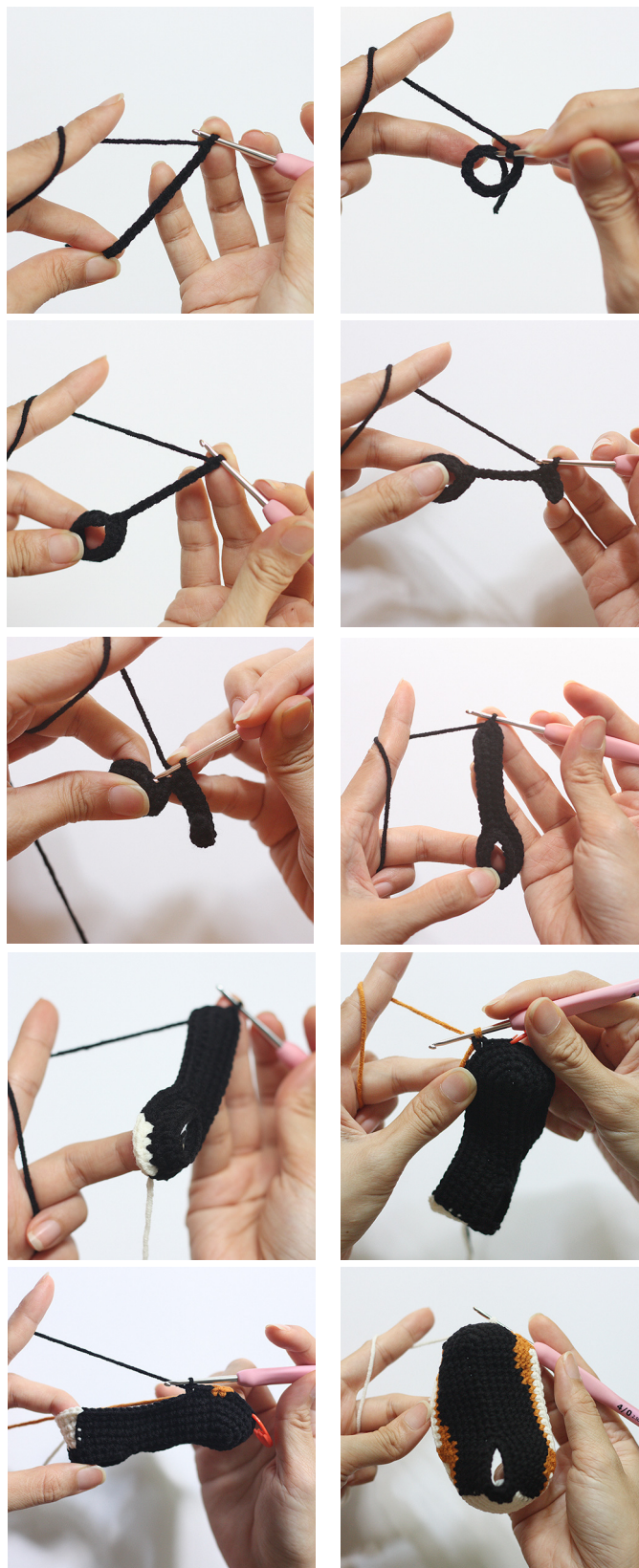
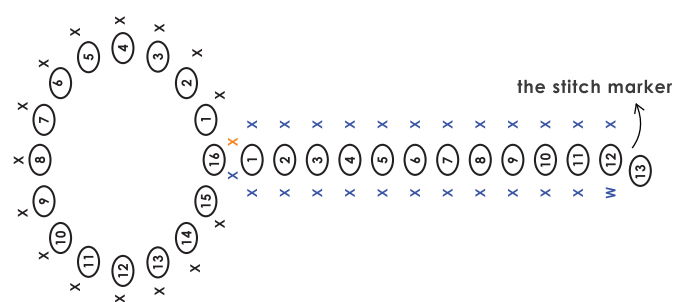

LEGS

First, You need mark the position of the 4 legs:

1 st for space on middle back form last st on

Rnd 11 of body,

10 st for the second leg, 9 st for space belly,

10 st for the third leg, 1 st for space on middle front,

10 st for the fourth leg, 9 st for space belly,

10 st for the first leg,

(I do not cut white yarn on Rnd 11 of body,

first I made leg 1)

Leg 1:

Continue white yarn of last st round 11 of the body,
on the right-hand side.

Rnd 1: 5 chain, 10 sc on the body [15]

Rnd 2: 5 sc on the chain, 10 sc on the body [15]

Rnd 3 - Rnd 4: 15 sc [15]

Rnd 5: (3 sc, 1 dec) x 3 [12]

Rnd 6: 12 sc [12]

Rnd 7: 2 sc, 4 inc, 6 sc [16]

Rnd 8: 2 sc, (1 inc, 1 sc) x 4, 6 sc [20]

Rnd 9: (3 sc, 1 dec) x 4 [16]

Rnd 10: 8 dec [8]

Fasten off and leave a long tail for sewing.

Using your yarn needle, weaves the yarn tail
through the front loop of each remaining stitch
and pull it tight.

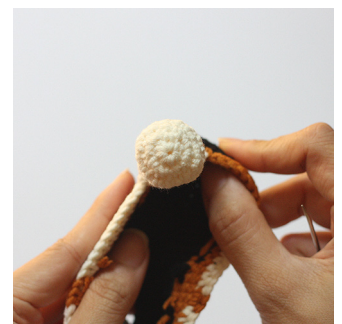

Leg 2:

Skip next 1 st on round 11 of body after leg 1, on the left-hand side.

Join white yarn in this stitch.

Start the second leg:

Rnd 1: 10 sc on the body, 5 chain [15]

Rnd 2: 10 sc on the body, 5 sc on the chain [15]

Rnd 3 - Rnd 4: 15 sc [15]

Rnd 5: (3 sc, 1 dec) x 3 [12]

Rnd 6: 12 sc [12]

Rnd 7: 6 sc, 4 inc, 2 sc [16]

Rnd 8: 6 sc, (1 inc, 1 sc) x 4, 2 sc [20]

Rnd 9: (3 sc, 1 dec) x 4 [16]

Rnd 10: 8 dec [8]

Fasten off and leave a long tail for sewing.

Using your yarn needle, weaves the yarn tail through the front loop of each remaining stitch and pull it tight.

Leg 3:

Skip next 9 st on round 11 of body after leg 2, on the left-hand side.

Join white yarn in this stitch.

Start the third leg:

Rnd 1: 10 sc on the body, 5 chain [15]

Rnd 2: 10 sc on the body, 5 sc on the chain [15]

Rnd 3 - Rnd 4: 15 sc [15]

Rnd 5: (3 sc, 1 dec) x 3 [12]

Rnd 6: 12 sc [12]

Rnd 7: 6 sc, 4 inc, 2 sc [16]

Rnd 8: 2 sc, (1 inc, 1 sc) x 4, 6 sc [20]

Rnd 9: (3 sc, 1 dec) x 4 [16]

Rnd 10: 8 dec [8]

Fasten off and leave a long tail for sewing.

Using your yarn needle, weaves the yarn tail through the front loop of each remaining stitch and pull it tight.

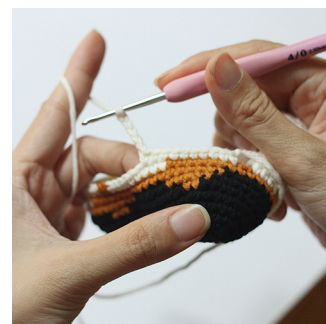

Leg 4:

Skip next 1 st on round 11 of body after leg 1, on the left-hand side.

Join white yarn in this stitch.

Start the four leg:

Rnd 1: 10 sc on the body, 5 chain [15]

Rnd 2: 10 sc on the body, 5 sc on the chain [15]

Rnd 3 - Rnd 4: 15 sc [15]

Rnd 5: (3 sc, 1 dec) x 3 [12]

Rnd 6: 12 sc [12]

Rnd 7: 2 sc, 4 inc, 6 sc [16]

Rnd 8: 8 sc, (1 inc, 1 sc) x 4 [20]

Rnd 9: (3 sc, 1 dec) x 4 [16]

Rnd 10: 8 dec [8]

Fasten off and leave a long tail for sewing.

Using your yarn needle, weaves the yarn tail through the front loop of each remaining stitch and pull it tight.

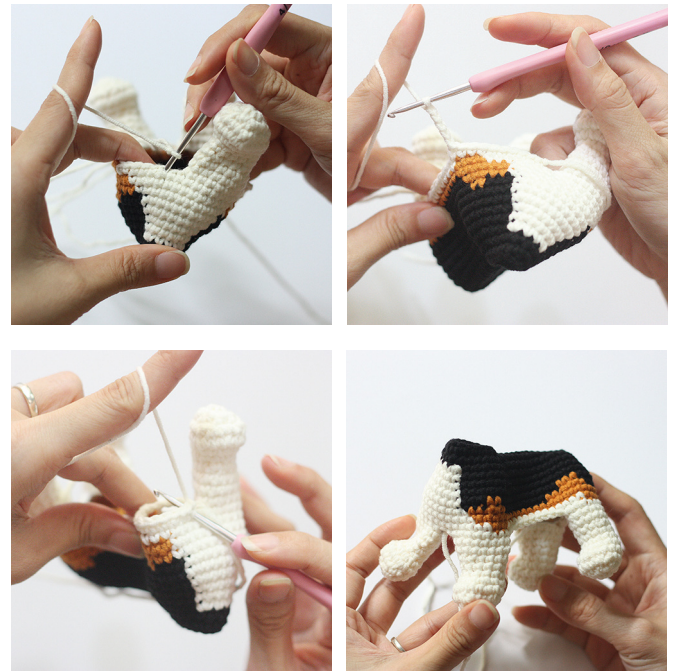

BELLY

Join white yarn to round 11 of the body, on the right-hand side of the 9 st space belly between leg 1 and leg 4, work in rnds:

Rnd 1 - Rnd 3: 1 chain, 9 sc, turn [9]

Rnd 4 : 1 chain, 9 sc, 3 chain, turn [9]

Rnd 5: 1 chain, 12 sc, 3 chain, turn [12]

Rnd 6: 1 chain, 12 sc, turn [12]

Rnd 7 - Rnd 9: 1 chain, 9 sc, turn [9]

Fasten off and leave a long tail for sewing.

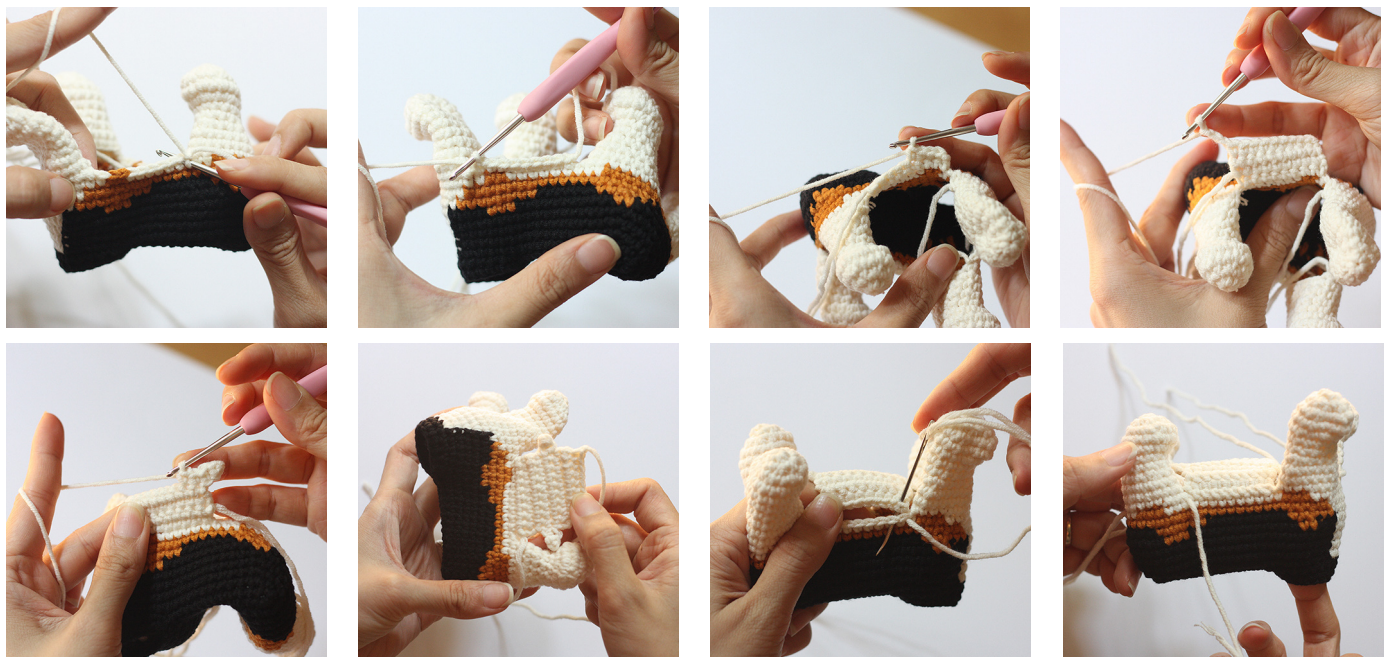

* All right reserved.

This pattern is only for personal use.

This pattern can not be sold
and distributed in any form.

You may sell items made from this pattern,
provided a credit to @PikiCraftvn as a designer.

Have fun crocheting time. Thank you!



Tony the Beagle Pattern
is pulished in July 2021 • PikiCraft