

Crochet pattern | US crochet terms

ENGLISH



REVERSIBLE FLOWER BOUQUET & BRIDE

Amigurumi

Difficulty Level: Intermediate - Advanced
Crochet pattern by Febby Pranajaya @chibiscraft

DISCLAIMER



Hello! thank you for choosing this pattern. This pattern is for your personal use only. Please do not reproduce, distribute, or resell it, in parts or in its entirety, in any format or translation. However, you may sell finished handmade items made from this pattern as long as they were made by yourself in a limited number. Please give credit to Chibiscraft as the pattern designer.

If you are going to share pictures on instagram, please remember to:

- insert *Pattern by @chibiscraft
- use hashtag #chibiscraftpattern

Please do not hesitate to contact me if you need any clarifications.



e-mail: chibiscraft@gmail.com



<https://www.instagram.com/chibiscraft>



<https://www.facebook.com/chibiscraft>

TIPS

- Try working tight stitches. Use a smaller crochet hook for better result.
- **IMPORTANT NOTE:**
 - Do not work too tight, so the plushie is still stretchable.
 - Work every part using the same stitch tension.
- Count your stitches.
- Use a stitch marker or a piece of yarn to mark ending or beginning of the round
- Each round is worked in a continuous spiral. Do not join rounds with slip stitch or turn unless stated otherwise.
- Crochet through both loops unless stated otherwise.
- It is highly recommended that you read through the pattern completely before beginning to crochet.

ABBREVIATION

This pattern is written in US Standard Crochet Terms, and assumes knowledge of basic stitches.

- R = row/Round
- MR = magic ring
- st = stitch/stitches
- sc = single crochet
- inc = sc increase (2 sc in the same st)
- inc3 = 3 sc in the same st
- dec = sc decrease (crochet 2 st together)
- TIPS: Use invisible decrease for better finish
- hdc = half double crochet
- hdc inc = 2 hdc in the same st
- dc = double crochet
- ch = chain
- sl st = slip stitch
- FL = Front loop/loops
- BL = Back loop/loops
- BLO = BL only
- FLO = FL only
- S = hair strand
- [] = repeat sequence between the square brackets for the indicated number of times
- () = stitch count at the end of the row/round

MATERIAL

- 2.0 mm hook or size suitable for yarn used
- Tapestry needle, embroidery needle, pin needle
- Fiberfill for stuffing
- Yarn in the same size (I used 4 ply, cotton blend yarn) in the following colors: white, cream, skin color (I also used cream as skin color), light pink, pink, light peach, peach, green
- Scissors
- multipurpose glue (*optional*)
- stitch markers

DIMENSION

The size will vary, depending on the yarn used. If you use the same materials as me, the finished amigurumi is about 10.5 cm (4.1") tall for bride side and 7 cm (2.76") tall for flower bouquet side.

Invisible Finish

After completing the last st, cut the yarn and pull on the loop to draw the tail. Using the tapestry needle, skip the next st, and insert the needle from front to back, under both loops. Go back to the last st, and insert the needle through the back loop of this st. Pull on the tail.

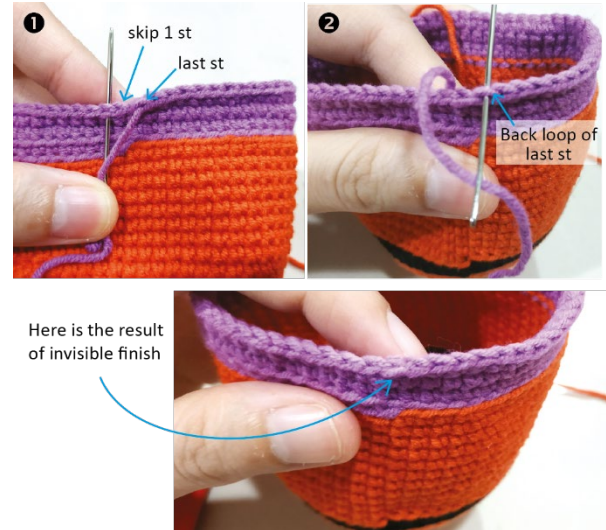

BRIDE'S HEAD AND BODY

Start with **skin color** yarn

R1	: 6sc in MR	(6)
R2	: 6inc	(12)
R3	: [sc, inc]x6	(18)
R4	: [sc, inc, sc]x6	(24)
R5	: [5sc, inc]x4	(28)
R6-12 (7 rounds):	28sc	(28)
R13	: [5sc, dec]x4	(24)
R14	: [sc, dec, sc]x6	(18)

Start stuffing with fiberfill.

R15	: [sc, dec]x6	(12)
R16	: FLO [sc, inc]x6	(18)

Change to **white** yarn.

R17-18 (2 rounds):	18sc	(18)
--------------------	------	------

Fasten off, leave a long tail for sewing. Do an invisible finish.

Attach the arm to the body with **the wrong/ugly side faces outside**, between R16-17.



BRIDE'S ARMS (make 2)

Start with **skin color** yarn. Make 12ch. Start from the second loop from the hook, make 11sc. Fasten off, leave a long tail for sewing.



BRIDE'S HAIR

Start with **light brown** yarn

R1	: 8sc in MR	(8)
R2	: 8inc	(16)

sl st to the first st of R2. Then continue to make the hair strands.

Strand 1 : 14ch. Start from the second loop from the hook: sl st, 12sc. Sl st to the next st

Strand 2-5 : 8ch. Start from the second loop from the hook: sl st, 6sc. Sl st to the next st

Strand 6 : do the same as strand 1

Strand 7-16 : 16ch. Start from the second loop from the hook: sl st, sc, 13hdc. Sl st to the next st

Fasten off, leave a long tail for sewing.

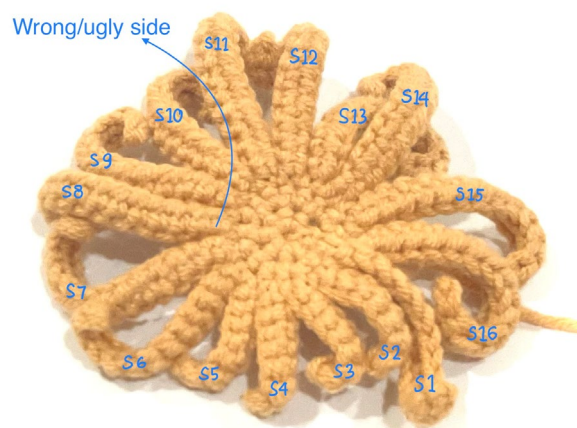

Hold the skirt with its bottom facing you. Attach the **light peach yarn** at the FL of R16 (you worked R17 BLO). Work: [sl st, sc, hdc inc, sc]x13, 2sl st. Fasten off, secure and hide the tail.

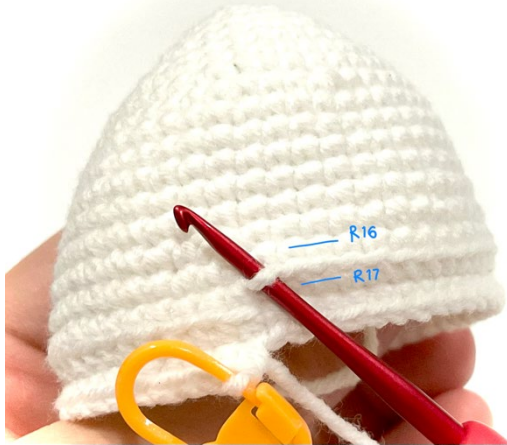

Hold the bouquet with its opening part facing you. Attach the cream yarn at the FL left of R3 (you worked R4 BLO). Make 1ch.

R1 : [hdc, hdc inc]x9 (27)

R2 : [2hdc, hdc inc]x9 (36)

R3-4 (2 rounds) : 36hdc (36)

Fasten off. Do an invisible finish and secure and hide the tails.



BOUQUET WRAPPER

Start with **cream** yarn. Leave a long starting yarn tail, approximately 10 cm (4"). This tail will be used to join both bouquet and bride at the end of this pattern.

R1 : 6sc in MR (6)

R2 : 6inc (12)

R3 : [sc, inc]x6 (18)

R4 : BLO [sc, inc, sc]x6 (24)

R5 : [3sc, inc]x6 (30)

R6 : [2sc, inc, 2sc]x6 (36)

R7 : [5sc, inc]x6 (42)

R8 : 42sc (42)

R9 : [3sc, inc, 3sc]x6 (48)

R10-13 (4 rounds) : 48sc (48)

R14 : [7sc, inc]x6 (54)

R15-18 (4 rounds) : 54sc (54)

Fasten off. Leave a long tail for sewing, about 50 cm long.



RIBBON

Work in rows. Start with **peach** yarn. Make 25ch. Then, start from the second loop from the hook:
 R1 : [2sc, 2hdc, 4dc, 2hdc, 2sc]x2 (24), 1ch
 R2 : turn, BLO [2sc, 2hdc, 4dc, 2hdc, 2sc]x2 (24)
 Fasten off, leave a long tail. Fold the bow so that both ends meet in the middle. Make a knot using both yarn tails to fix the position of the folded ribbon.



Then, make a bow's tail using the same color yarn. Make a MR, Then work: [10ch, start from the third loop from the hook: 5dc, 2hdc, sc. Sl st to the MR]x2. Pull tight the MR and fasten off. Using the yarn tail, attach the bow's tail to the center back of the bow. Let its wrong/ugly side faces outside.



Using white yarn, make some turns to create the central part of the bow. Secure the ends. Leave a long tail for sewing.



And then, sew the ribbon to the bouquet, near to its bottom.



Now, we will make some flowers. The number of each flowers that I wrote below is just a recommendation, but you can make them as many as you like.

FLOWER 1 (make 6)

Make 1 in pink and white. Make 2 in light pink and light peach. Make 6ch. Start from the second loop from the hook: hdc, hdc inc, hdc, 2ch, hdc inc in the same st, 2ch, hdc inc in the next st, 2ch, hdc in the same st, hdc, 2ch, hdc inc in the same st.

Fasten off, leave a long tail for sewing. Roll up the flower and sew it together so that it won't roll open.



FLOWER 2 (make 10)

Make 6 in light peach, 3 in light pink, and 1 in pink. Make 6ch. Start from the second loop from the hook: sc, inc, 3inc3.

Fasten off, leave a long tail for sewing. Roll up the flower and sew it together so that it won't roll open.



FLOWER 3 (make 3)

Use the white yarn.

In a MR, make: [4ch, sl st to the MR]x5. Tighten the MR. Fasten off, leave a long tail for sewing.



LEAVES 1 (make 3)

Start with green yarn.

Make 5ch, start from the second loop from the hook, make sl st, sc, hdc, sl st. Don't cut the yarn and make again 4ch, start from the second loop from the hook, make sl st, sc, sl st.

Fasten off. Leave a long tail for sewing.



LEAVES 2 (make 3)

Start with green yarn.

Make 4ch, start from the second loop from the hook, make sl st, sc, sl st.

Fasten off. Leave a long tail for sewing



Then, attach the flowers and the leaves on top of the bride's head



Attach the bride's body to the skirt between R3-4. No need to stuff the body with fiberfill, or just stuff it slightly.



Then, attach the ends of the arms, the leaves 1 and 3 pieces of flower 2 (in light pink and light peach) at the skirt.



JOINING THE BOUQUET WRAPPER & THE BRIDE'S SKIRT

Turn the bouquet wrapper and the bride's skirt inside out with the wrong/ugly sides facing you. Tie a knot with the yarn tails from the magic rings of both bouquet wrapper and the bride's skirt, leaving a space between them.

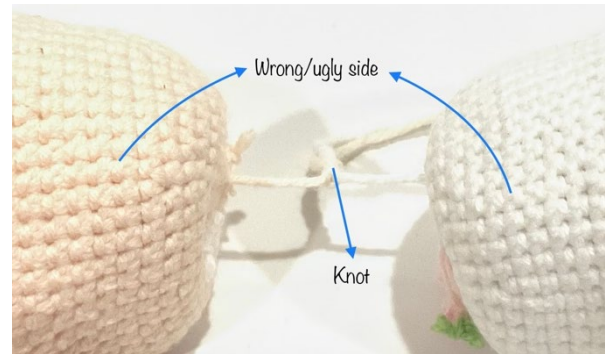

Turn the bouquet wrapper back with the right/good side facing you, and leave the skirt intact at the wrong/ugly side. No need to stuff with fiberfill. Push the skirt inside the bouquet wrapper.



Join the last rounds of the bouquet wrapper and the bride. Sew them together with light pink tail through the BL of each piece. To finish, make a knot and hide the tail.



After joining the bouquet and the bride's skirt, Continue working the bouquet side. Hold the bouquet with its flowers facing you. Attach the cream yarn to the FL of R18. And work: [sl st, sc, hdc inc, sc]x13, 2sl st. Fasten off, secure and hide the tails.



Now, turn the bouquet inside out so the bride is facing outside, because now we are going to work the bride's side.

Hold the bride with her skirt facing you.

With the **white yarn** tail left from the last round of the bride's skirt (page 4)*, work at the FL R18: ch1, sc at the same st, [sl st, sc, hdc inc, sc]x13, sl st.

Fasten off, do an invisible finish, secure and hide the tail.



Congratulation! Your reversible flower bouquet and bride amigurumi is ready. I hope you enjoyed crocheting them. And if you like this pattern, do not hesitate to give it a review. It will be my big pleasure to see your finished amigurumi with hashtag #chibiscraftpattern, or add a Ravelry project.

Have a nice day!

with love, Febby Pranajaya

♥ Special thanks to my pattern testers who helped me a lot in improving this pattern:

Rahma @mercy_handmade,

Nani @geekoutthreads, and

YP @mai.crochet ♥